



The US Geospatial Platform Initiative

Geospatial Policies and Programs

Geobuiz Conference

August 11, 2015

Agenda

- 01 Geospatial Platform - History and Current Capabilities
- 02 Capabilities Coming Soon
- 03 How Does This Advance the US NSDI?
- 04 Discussion

CAPABILITIES

COMING SOON

ADVANCING THE NSDI

DISCUSSION

Geospatial Platform – History and Current Capabilities

Geospatial Platform Value Proposition

- The value of geospatial data and tools are now recognized across nearly all lines of government business.
- But major challenges remain:
 - Inconsistent success in discovering and accessing the right data at the right time
 - Inability to surface our authoritative / key national data in search results
 - Incomplete and inconsistent portfolio of “nationally significant” geospatial data
 - Slow rate of adoption for technological innovation
 - Difficulty leveraging and re-using innovations (tools, analytical capabilities, etc.) developed elsewhere in government

CAPABILITIES

COMING SOON

ADVANCING THE NSDI

DISCUSSION

Business Drivers

- Budget Language, FY11 Direction to create the “Geospatial Platform”
- Deepwater Horizon and future multi-agency data publication / mapping requirements
- Desire to leverage partnerships developed in and funding supplied to FGDC for providing operational support
- Data.gov
- OMB / Federal IT Shared Services
- Executive Order on Open Data
 - White House Climate Data Initiative
 - Departmental Open Data Initiatives

CAPABILITIES

COMING SOON

ADVANCING THE NSDI

DISCUSSION

Timeline of Geospatial Platform Activity

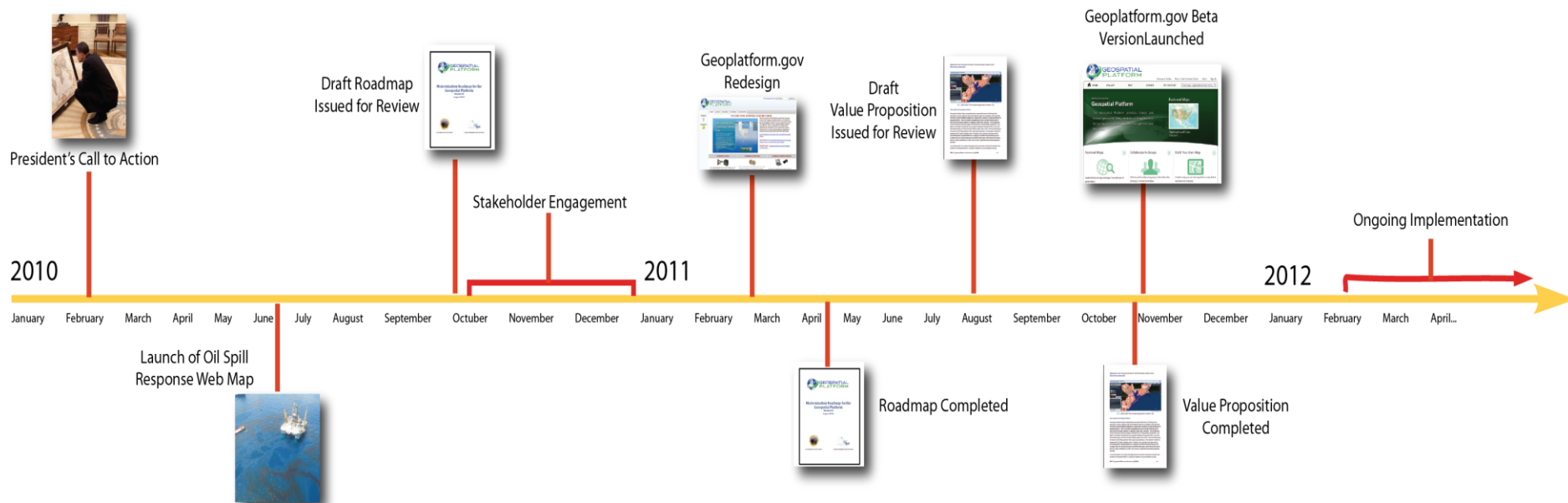

Most Recent Products of Note (see: <http://www.fgdc.gov>)
National Spatial Data Infrastructure Strategic Plan (2014-2016)
National Geospatial Data Asset Management Plan

CAPABILITIES

COMING SOON

ADVANCING THE NSDI

DISCUSSION

Geospatial Platform Components

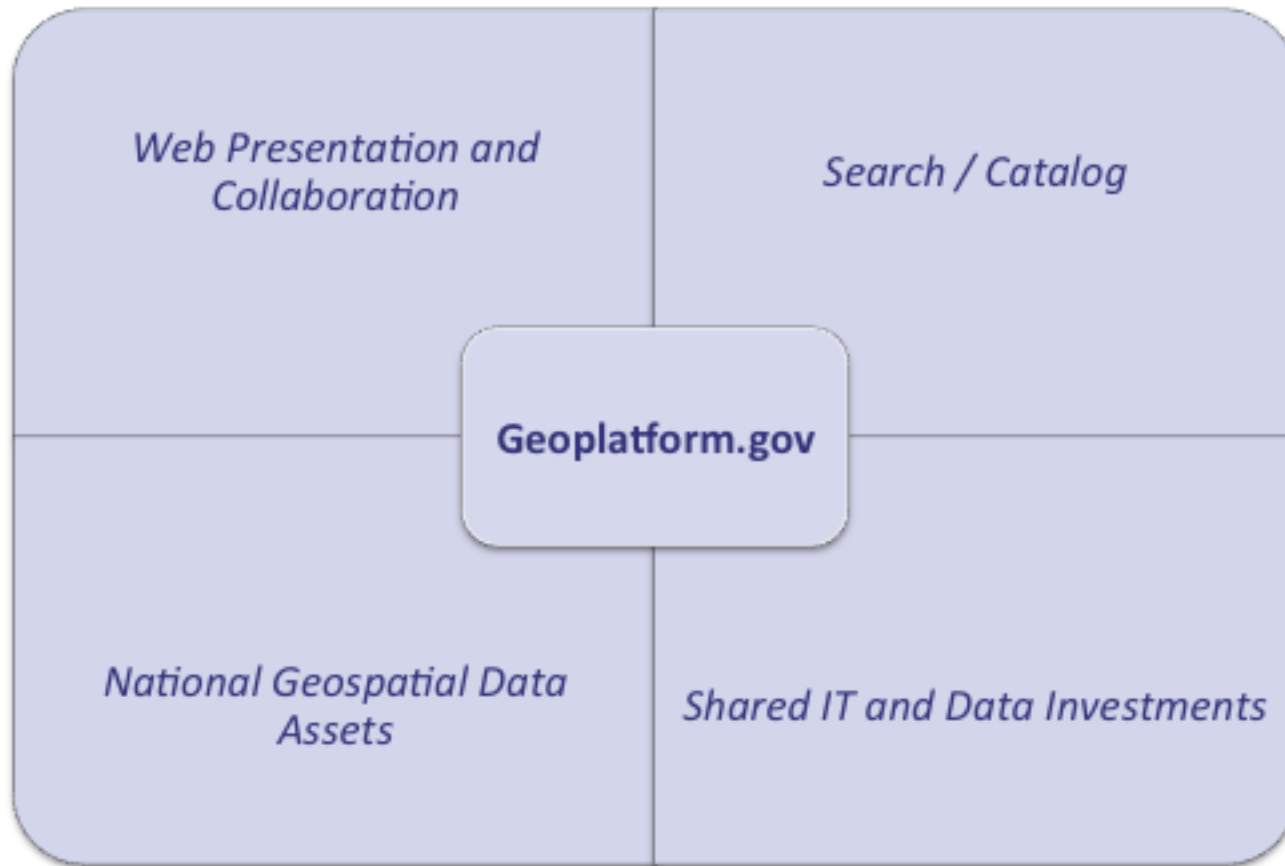

CAPABILITIES

COMING SOON

ADVANCING THE NSDI

DISCUSSION

Geospatial Platform - Website

- Home page features topical maps, data & stories
- Website presents content in “Communities”
 - Data Themes of National Spatial Data Infrastructure
 - Interagency Communities
- Growing content within existing communities and considering new ones for launch in coming months

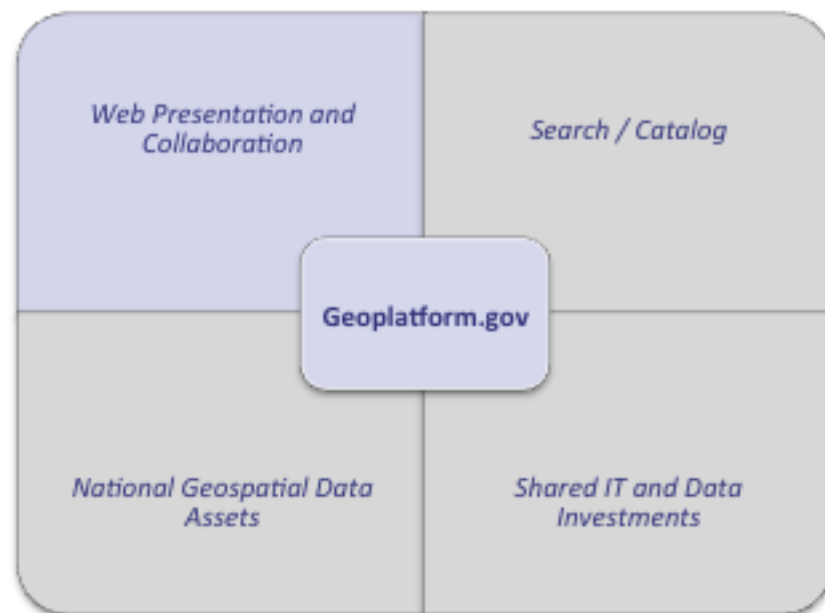



Explore

Develop

Publish

The Geospatial Platform Releases New Data Viewer

Your taxpayer investment in environmental data just got a lot more valuable. Now instead ...

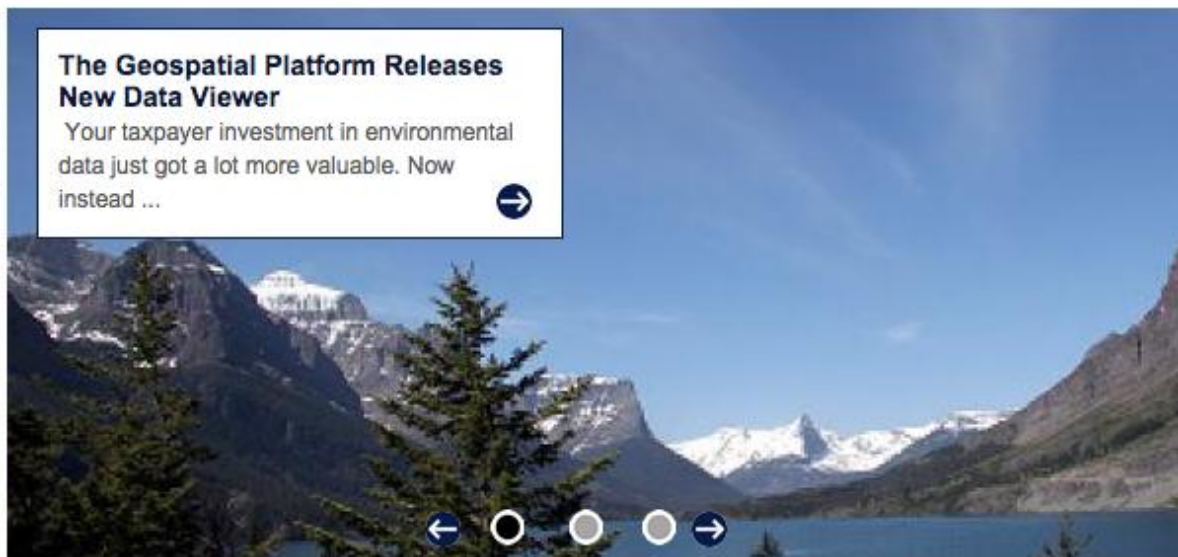

Search Data Catalog

95,809 Datasets

Search geospatial datasets by terms above...

[Learn More](#)

News & Blogs - What's in the news and the latest information about Geoplatform

Site Statistics & Data Metrics - site usage, popular pages, organizational dataset counts and updates.

Featured Applications



GeoPlatform - Climate Resources

Find data and tools related to climate change

Trending Data

U.S. Hourly Precipitation Data

Hourly Precipitation Data (HPD) is digital data set DSI-3240, archived at the National Climatic Data Center (NCDC). The primary source of data for this file is approximately 5,500 US National...

Great Chile Earthquake of May 22, 1960 - Anniversary Edition

On May 22, 1960 (19:11 UTC), a Mw 9.5 earthquake occurred in southern Chile (39.5 S, 74.5 W). This was the largest earthquake ever instrumentally recorded. (It was not the largest in terms o...

Military Installations, Ranges, and Training Areas

Featured Maps

Sea Level Rise Planning Tool - New Jersey and New York State



NOAA, in partnership with FEMA, USACE, USGCRP, and CEQ has created a set of map services and related tools to help communities, residents, and other stakeholders consider risks...

[View Details](#)

Exploring Ocean Wind Energy



Homeland Security Geospatial Concept Of Operations

Home | Data | HLS Missions | Tools | Best Practices | Forum | About Us



Homeland Security GeoCONOPS

"A Whole of the Nation Approach..."

[What is the HLS GeoCONOPS?](#)

[Who are the HLS GeoCONOPS Stakeholders?](#)

[How do I use the HLS GeoCONOPS?](#)

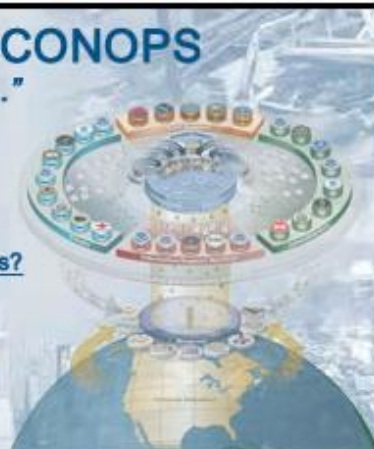

Authoritative Data



For the purpose of the GeoCONOPS, authoritative data classifications provide clarity beyond the frequent notion that an authoritative data source

Best Practices

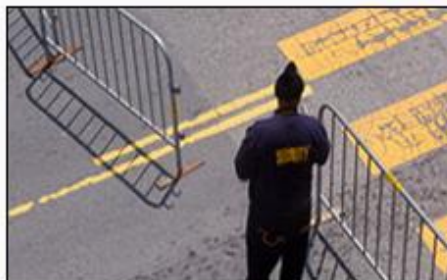

The GeoCONOPS Best Practices highlight more than a dozen mature methods and innovative practices for geospatial management processes,

Community Forum



Join our discussion community!

Homeland Security Geospatial Concept Of Operations

Community Type: Agency

Sponsor: Department of Homeland Security (DHS) Geospatial Management Office (GMO)

Sponsor Email: GMO@hq.dhs.gov

You must register or login in order to subscribe to this community.

Geospatial Platform – Search / Catalog

The screenshot shows the Geoplatform.gov Dataset Catalog interface. On the left, there is a sidebar with filters: 'Filter By Location' (with a map of North America), 'Dataset Type' (showing 'Geospatial (75723)' selected), 'Tags' (with 'Temperature (25728)', 'Physical (22937)', 'Profile (20342)', 'Unknown (14640)', and 'Water Depth (14480)'), and 'Formats' (showing 'HTML' selected). The main content area is titled 'Dataset Catalog' and includes a search bar, a 'Search' button, and a dropdown for 'Order by: Popular'. Below this, it states '75,723 datasets found'. Three dataset entries are visible, each with a 'Federal' label: 1. 'TIGER/Line Shapefile, 2013, Series Information File For The Current Metropolitan Statistical Area/Micropolitan Statistical Area (CBSA) National' by the US Census Bureau. 2. 'Great Chile Earthquake Of May 22, 1960 - Anniversary Edition' by the National Oceanic and Atmospheric Administration. 3. 'TIGER/Line Shapefile, 2012, Series Information File For The 2010 Nation, 2010 Census 5-Digit ZIP Code Tabulation Area (ZCTA5) National' by the US Census Bureau.

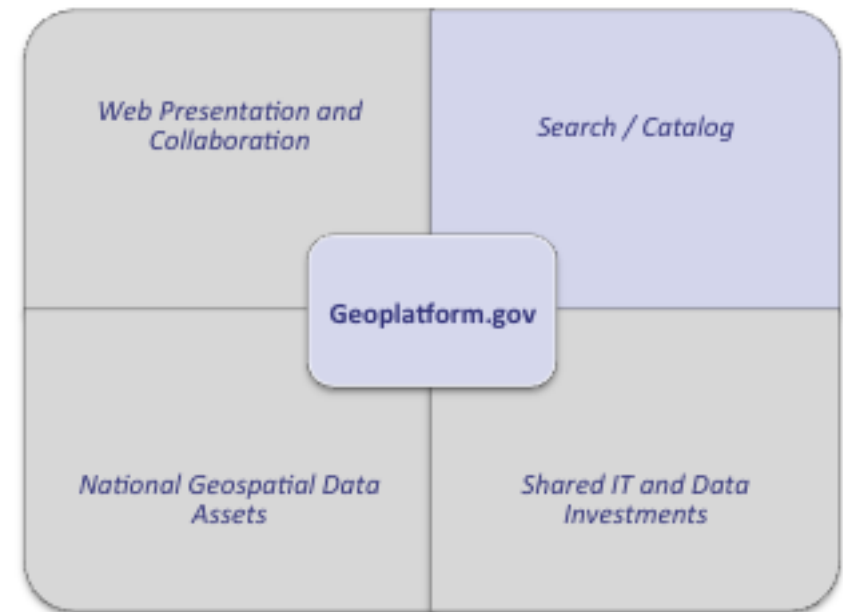

- One stop shopping for government geospatial data & tools: ~**85,000** datasets, tools, maps and applications
- Close partnership w/ Data.gov team & White House Offices
- Planning major redevelopment of discovery capabilities

CAPABILITIES

COMING SOON

ADVANCING THE NSDI

DISCUSSION

Geospatial Platform – Shared Investments

- Common data / application hosting infrastructure to enable agencies to save time and money
 - Leveraging ArcGIS Online
 - Using commercial cloud computing services to build out additional shared hosting infrastructure for the benefit of FGDC partners

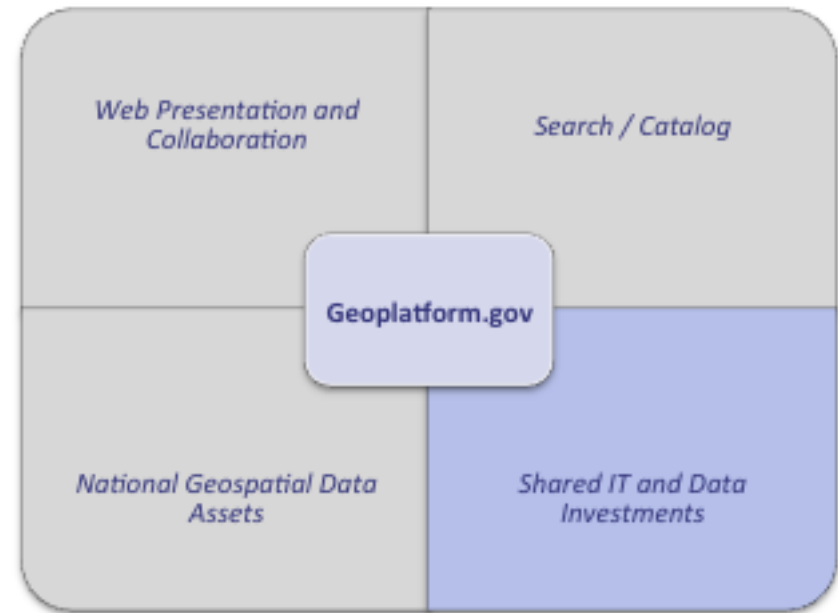

Developing shared IT security documentation for the common hosting environment – leveraging DOI Foundational Cloud Hosting Contract and existing relationship with Esri

CAPABILITIES

COMING SOON

ADVANCING THE NSDI

DISCUSSION

Geospatial Platform – NGDAs

- In developing Supplemental Guidance for Circular A-16, FGDC established concept of “National Geospatial Data Assets”
 - Roughly 170 data layers of the highest importance to agencies and external stakeholders
- FGDC has established Management Plan for improving management and publication
- Geospatial Platform provides hosting and collaboration support
- **100%** of NGDAs now registered on Geoplatform.gov!

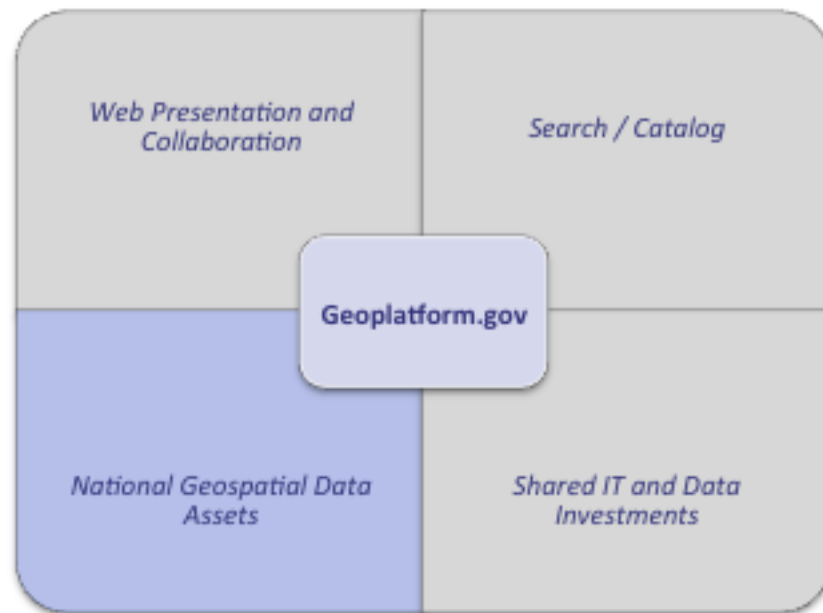

Components of the Department of the Interior have “Theme Lead” or co-lead responsibilities for 11 out of 16 NGDA Themes that have been established by the FGDC

CAPABILITIES

COMING SOON

ADVANCING THE NSDI

DISCUSSION

Capabilities Coming Soon

Near Term and Planned New Features

- A complete redesign and redeployment of Geoplatform.gov and its underlying capabilities
- Hosted in a commercial cloud environment (Amazon Web Services)
- Greatly increased capabilities and performance
- **Summer 2015 “Preview” Release**
 - New home page / web design
 - New Web Map Viewer with integrated service quality measures
 - Improved capabilities for map gallery creation and sharing
 - Expanded performance and portfolio measurement tools

CAPABILITIES

COMING SOON

ADVANCING THE NSDI

DISCUSSION

Welcome to GeoPlatform.gov

The GeoPlatform provides shared and trusted geospatial data, services, and applications for use by the public and by government agencies and partners to meet their mission needs.

GeoPlatform users have access to

- A one-stop shop to deliver trusted, consistent data & services
- Authoritative data to support informed decision making
- Reusable applications and services for Federal govt and non-govt use
- A shared infrastructure to host data and applications
- A focal point where governmental, academic, private, and public data can be visualized together to inform and address national and regional issues

[Sign up!](#)

The screenshot shows the 'GeoPlatform.gov Map Manager' interface. It includes a search bar, a grid of map thumbnails, and a sidebar with filters. The maps displayed include 'Study Area', 'Middle Carson River Basin', and 'USGS gaging stations in Carson River Basin'. Each map has a title, a description, and metadata such as author and creation date.

Featured: GeoPlatform Release Preview

WHAT'S NEW



Featured App: Web Map Viewer

Browse thousands of WMS and ESRI-hosted map layers, construct maps, and more with the new and improved Web Map Viewer!

[Launch WMV](#)

Map Collaboration

Learn how to compose and share maps using open services with GeoPlatform.

[Learn more](#)

AGOL Map Harvester

Quickly and easily integrate existing ArcGIS Online maps into your GeoPlatform pages using the Map Harvester service!

[Learn more](#)

First Time Here?

GeoPlatform.gov was created to enhance geospatial resource sharing across the U.S. Government and the world, and to allow users like you to participate in an online geospatial services experience. Whether you want to discover and use up-to-date National Geospatial Data Assets, make a shared Open Map Gallery for your website, integrate quality National data into your own web application, or more, GeoPlatform.gov is a place to stay connected to a fast evolving geospatial service ecosystem.



Create an Account

With an account, you can access thousands of datasets uploaded by others and contribute your



Collaborate with Others

[Share](#) your expertise or find experts to help with your geospatial data needs, join one of



Register your Data

Register your data in [Data.gov](#) and we'll add it to GeoPlatform.gov so others can

My Account

Already have an account? Go ahead and login! Don't have an account? Sign up now. It's quick and free!

[Login](#)[Create an Account](#)

★ Featured Communities

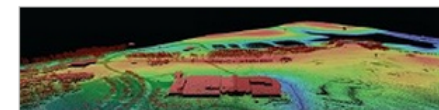

Browse Layers

Apply

Search Layers

Search for layers by name

Q

Search layers

Sort Layers

Name

Ascending

Layer Sources

AssistedHousing

7

BISON

5309

Biology WMS Layers from the National Atlas of the United States

1454

Climate WMS Layers from the National Atlas of the United States

93

Layer Types

All Amphibians (Amphibia)

388

All Gymnosperms (Gymnospermae)

244

All Mammals (Mammalia)

800

All Mustards (Brassicaceae)

761

All Oaks (Quercus)

167

Available Layers

Select layers below to view them on the preview map at right.

11568 results10 per page12345»

1 to 25999

NGA GeoNames Scaled WMS

10-digit HU

USGS TNM National Hydrography Dataset, NGDA

10-digit HU

USGS TNM National Hydrography Dataset, hydrography, NHD, water, drainage, river, strea...

10-digit HU

USGS TNM National Hydrography Dataset, hydrography, NHD, water, drainage, river, strea...

10-digit HU

USGS TNM National Hydrography Dataset, hydrography, NHD, water, drainage, river, strea...

10-digit HU

USGS TNM National Hydrography Dataset, hydrography, NHD, water, drainage, river, strea...

1000000 to 7000000

NGA GeoNames Scaled WMS

113th Congressional Districts

NGDA, NTAD

12-digit HU

USGS TNM National Hydrography Dataset, NGDA

12-digit HU

USGS TNM National Hydrography Dataset, hydrography, NHD, water, drainage, river, strea...

Preview

+

-

Leaflet | Map data (c) OpenStreetMap contributors

Please be patient, some layers may take several seconds to appear.

Constrain the list of layers using geographic extents or named places

Specify a named location

Previewed Layers

Layers listed below are shown in the preview map above. Click 'Apply' at the top of this panel to add them all to the current map.

113th Congressional Districts

10-digit HU



Search by name or keyword

Author

Search by author

Sort

Updated



134 results

10 per page ▾

1

2

3

4

5



Add to Gallery

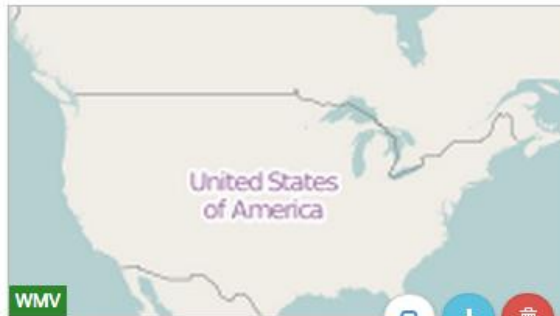

esri demo

esri demo

esri

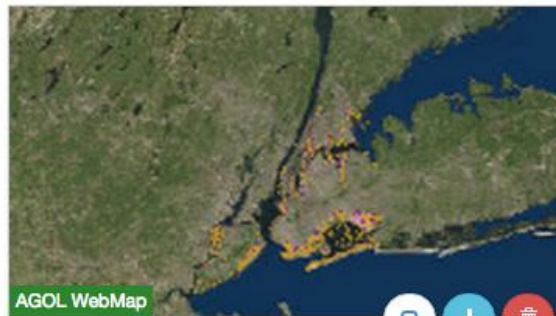
Author: Jerry Johnston (US Department of the Interior)**Created:** Jul 22, 2015 6:41:24 PM**Updated:** Jul 22, 2015 6:41:24 PM

Sea Level Rise Planning Tool - New York City

Future Sea Level Rise and Most Recent Special Flood Hazard Area

Climate Change, Coastal Flooding, Coastal Inundation, Hazards, Inundation, Sea Level Rise, Special Flood Hazard

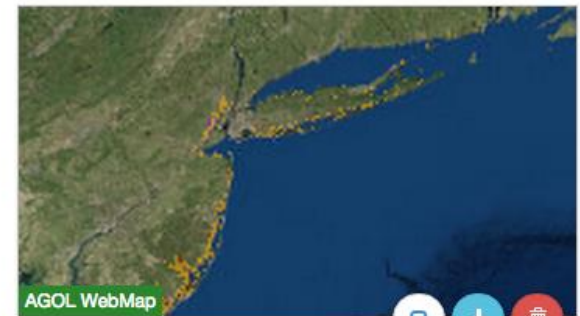
Author: NOAA_GeoPlatform (GEOPLATFORM.gov)**Created:** Jun 16, 2015 12:27:40 PM**Updated:** Jul 22, 2015 5:33:00 PM

Sea Level Rise Planning Tool - New Jersey and New York State (Nassau, Suffolk, and

Future Sea Level Rise and Most Recent Special Flood Hazard Area

Climate Change, Coastal Flooding, Coastal Inundation, Hazards, Inundation, Sea Level Rise, Advisory Base Flood

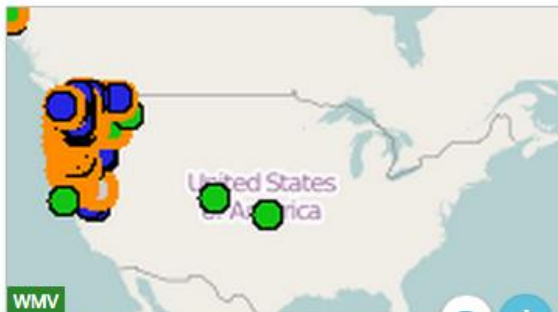
Author: NOAA_GeoPlatform (GEOPLATFORM.gov)**Created:** Jun 16, 2015 12:27:40 PM**Updated:** Jul 22, 2015 5:33:00 PM



Lifecycle Maturity

Select a NGDA Dataset Lifecycle Maturity Assessment survey from the drop-down below. Surveys are added quarterly, and include in the title their Fiscal Year and Quarter. You may choose to filter by Theme or Agency using the Selection Type and Selection drop-downs. For more details, click on a rating box (cell) or hover over column headings.

 **Legend**



Survey: FY 2015, 4th Quarter

Selection Type: By Theme

Selection: Biota

Export as: PDF



Dataset	General	Define	Inventory Evaluation	Obtain	Access	Maintain	Use Evaluation	Archive	Overall	Agency
Theme Rollup	3/5	3/5	1/5	2/5	4/5	3/5	4/5	3/5	3/5	
Bailey's Ecoregions And Subregions Of The United States, Puerto Rico, And The U.S. Virgin Islands - Direct Download	2/5	4/5	5/5	3/5	1/5	5/5	1/5	3/5	3/5	USDA-USFS
Environmental Sensitivity Index (ESI) Data Viewer and REST Services for Atlases	3/5	4/5	0/5	2/5	4/5	4/5	5/5	2/5	3/5	DOC-NOAA
FWS Critical Habitat for Threatened and Endangered Species Dataset	3/5	2/5	5/5	1/5	4/5	4/5	3/5	3/5	3/5	DOI-FWS
Omernik's Level III Ecoregions Of The Conterminous United States	3/5	3/5	0/5	2/5	4/5	4/5	5/5	2/5	3/5	USEPA
Terrestrial Ecosystems of the Conterminous United States	4/5	3/5	0/5	3/5	4/5	1/5	3/5	5/5	3/5	DOI-USGS
U.S. Geological Survey Gap Analysis Program Species Distribution Models	3/5	1/5	0/5	4/5	5/5	1/5	5/5	3/5	3/5	DOI-USGS
U.S. Geological Survey Gap Analysis Program Species Ranges	4/5	3/5	0/5	3/5	4/5	1/5	3/5	5/5	3/5	DOI-USGS

Tip: Hover over a column name to view the questions associated with it. Click the chart icon within a cell to view its visualized graph.

How Does This Advance the US NSDI?

Advancing the NSDI – By Lifecycle Component

Geospatial Platform Supports Multiple Aspects of the Geospatial Data Lifecycle

▪ Inventory

- Metadata catalog in partnership with Data.gov

▪ Obtain

- Geospatial Platform Marketplace allows partners to forge partnerships for acquisition and development

▪ Access

- Web services access via open standards is facilitated by shared infrastructure

▪ Maintain

- Quality of service indicators provided to users and to NSDI dataset maintainers

▪ Use

- Allow for development and sharing of maps as social objects
- Developer guidance and support for use of open APIs

CAPABILITIES

COMING SOON

ADVANCING THE NSDI

DISCUSSION

Advancing the NSDI – Other Examples?

What ideas from other NSDI efforts might we be able to learn from and implement as a part of our work in the United States?

CAPABILITIES

COMING SOON

ADVANCING THE NSDI

DISCUSSION

Discussion